

Deadbolt Handlesets Product Data

(Stainless Steel Metro & Urban Tubular Sets)

Available in two backsets – 2³/₈" or 2³/₄" (2³/₈" backset shipped standard). Please specify when ordering.

Features

- Our stainless steel tubular deadbolt handlesets each consist of a set of exterior trim, lever interior trim as selected, extra heavy duty tubular latch designed for levers and spindle, deadbolt assembly, cylinder, all necessary mounting screws and template.
- Backset:** Available with two backset options – 2³/₈" or 2³/₄" (2³/₈" backset shipped standard). Please specify when ordering.

Lock & Trim Functions

- F – Panic Proof:** Latchbolt operates by knob or lever inside, thumbpiece outside except when outside trim is locked by rocker switch. Deadbolt activated by key outside and turnpiece inside. Turning of inside knob or lever will retract both deadbolt and latchbolt at the same time.
- PD – Pair Dummy:** Dummy trim is non-operating and is mounted on the inside and outside of the door. Shipped pre-assembled.
- SDE – Single Dummy Exterior:** Dummy trim is non-operating and is mounted on the outside of the door. Thumbpiece is also non-operating. Shipped pre-assembled.
- SDI – Single Dummy Interior:** Dummy trim is non-operating and is mounted on the inside of the door. Shipped pre-assembled.

FINISH CODES

FINISH	DESCRIPTION	CODE
US32D	Satin Stainless Steel	32D
PBL*	PVD Black	PBL
PDB*	PVD Dark Bronze	PDB
PSG*	PVD Satin Gold	PSG
PTT*	PVD Titanium	PTT

*Only available for Urban

Metro Dimensions

5¹/₂" center to center
Exterior (Top Plate) & Interior:
 10¹/₄" x 2⁹/₁₆" x 7⁷/₁₆"
Exterior (Bottom Rose): 2¹/₁₆" dia.
Overall Exterior: 16⁷/₈" length x 3⁵/₁₆" proj.
Overall Interior: 10¹/₄" length x 2⁷/₈" proj.

Urban Dimensions

5¹/₂" center to center
Exterior (Top Plate) & Interior:
 10¹/₂" x 2¹/₂" x 7⁷/₁₆"
Exterior (Bottom Rose): 2" square
Overall Exterior: 16³/₄" length x 2³/₈" proj.
Overall Interior: 10¹/₂" length x 2⁵/₈" proj.

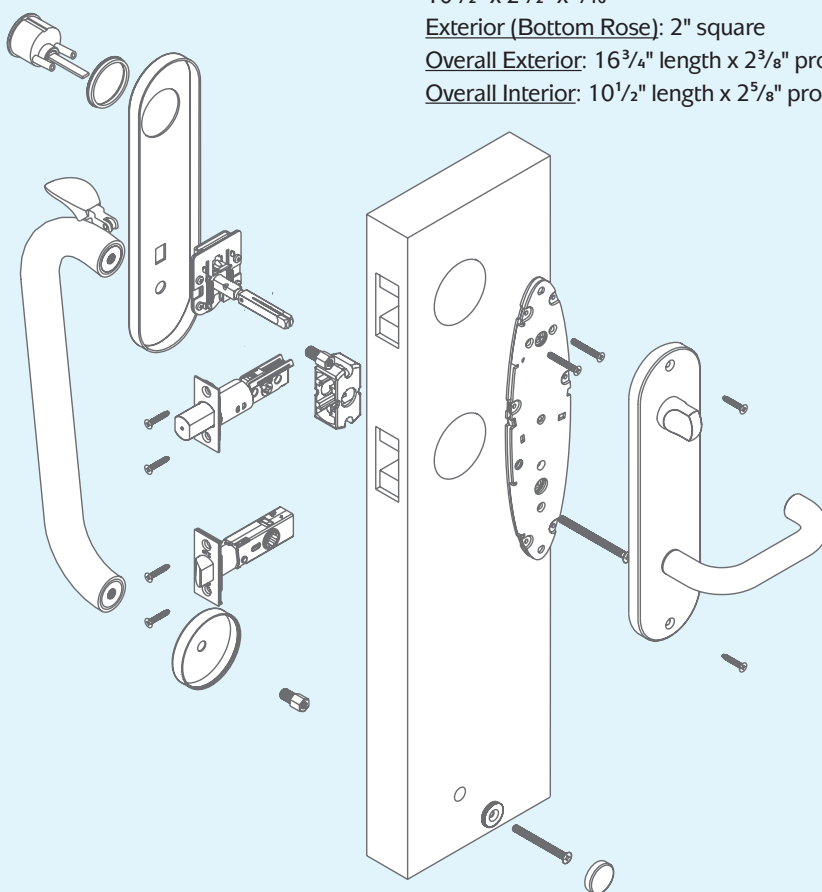

How to Order Deadbolt Handlesets

EXAMPLE: ACTIVE

Design	Function	Interior Trim	Backset	Finish
URBAN	F	012	38	32D
Urban or Metro	See Function Codes Above	3-Digit Interior Trim Option (See Pages 84-85)	38 = 2 ³ / ₈ " Backset 34 = 2 ³ / ₄ " Backset	See Finish Codes (Above)

Product order number would be **URBAN.F012.38.32D**
 or **URBAN.PD012.32D** for a pair dummy.

For doors over 1³/₄" thick, please specify door thickness.

For doors 2" thick or thicker, please call OMNIA for additional charges that may apply.