

## Latchset Component List

- |                                  |  |  |  |
|----------------------------------|--|--|--|
| A – Door Knob/Lever (2)          | G – Tubular Latch Faceplate                                  | L – Privacy Locking Block (For Privacy ONLY) | O – Privacy Locking Pin (For Privacy ONLY) |
| B – Set Screws (2)               | H – Tubular Latch Strike Plate                               | M – Thru-bolts (2)                           | P – Washer Installation Tool               |
| C – Nylon Threaded Washers (2)   | I – Metal Spring Assist Sub-Rose                             | N – Finished Rose                            | Q – Emergency Release Key                  |
| D – Finished Rose                | J – Privacy Locking Block Machine Screw (For Privacy ONLY)   |  |  |
| E – Metal Spring Assist Sub-Rose | K – Privacy Locking Block Locking Stopper (For Privacy ONLY) |  |  |
| F – Tubular Latch                |  |  |  |

### (55° Latch Parts)

- R – Adaptor R  
 S – Spindle (Teardrop groove positioned towards set screw)  
 T – Tubular Latch  
 U – Tubular Latch Faceplate  
 V – Adaptor V

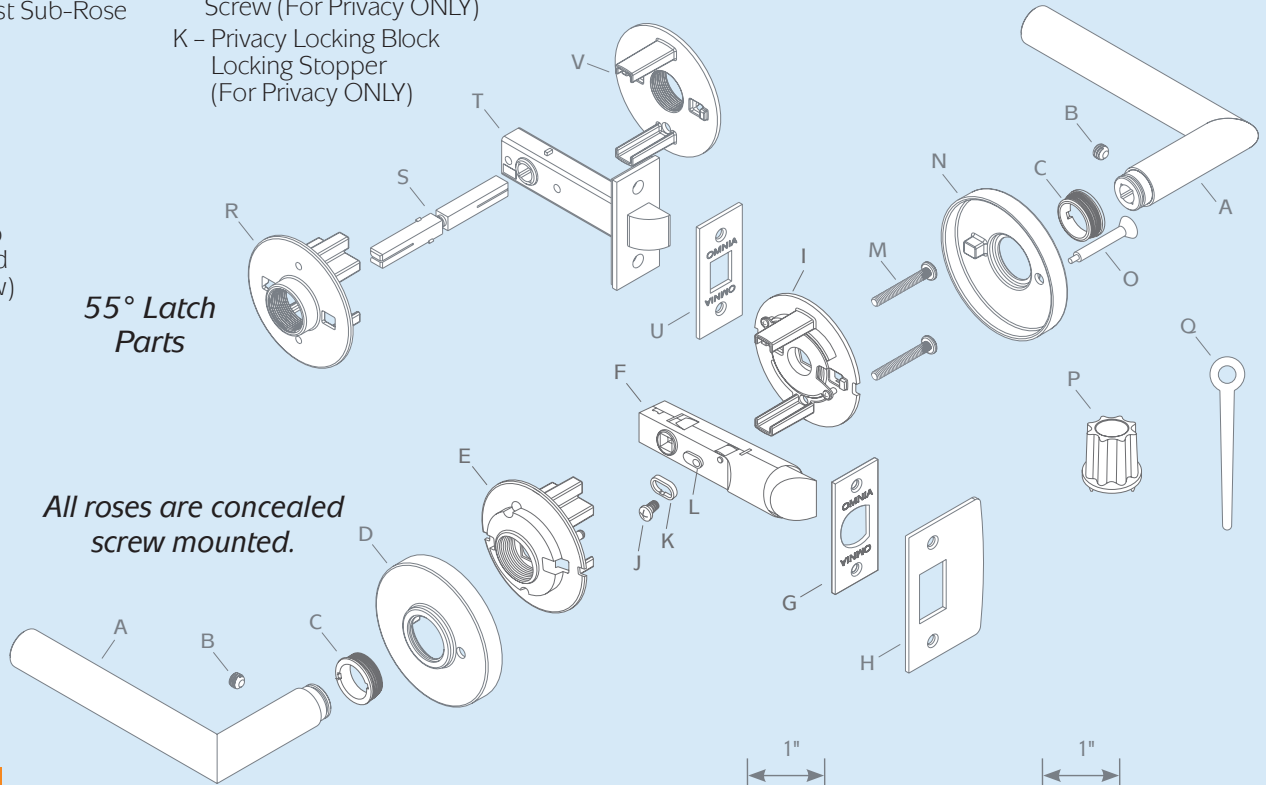

## Product Data

### Knob and Lever Latchset

- 2 3/8" (standard) and 2 3/4" backsets available.
- Supplied for both 1 3/8" and 1 3/4" door thickness as standard. The minimum door thickness is 1 1/4"; the maximum door thickness is 2 1/2" (*please specify*).
- All lever latchsets meet ADA accessibility requirements.

Each set consists of solid brass knobs or levers, thru-bolted rose mechanisms, finished rose covers, latch, strike, faceplate, spindle, all necessary mounting screws, installation template and instructions.

### About Our Tubular Latch

- 55° rotation to retract latch. (For Knobs)
- 28° rotation to retract latch. (For Levers)
- Tough, non-rusting materials used throughout. Face covers and strikes are solid brass. No.014 "Full Lip" strike supplied as standard or No.013 "T" strike as an option. (*Please specify*).
- For over five decades, OMNIA's latches have been opening and closing hundreds of thousands of doors all around the world.

### Functions

- **Passage:** Latch operates by knob or lever from either side of door.
- **Privacy:** Push pin provided for privacy inside room. Emergency release hole for outside room. Emergency release key also provided.
- **Single Dummy:** Trim on one side of door only. Available for surface mounting. Knob or lever with rose.
- **Pair Dummy:** Trim on both sides of door. Knob or lever with thru-bolted or concealed screw rose set.

