



# User Manual

EH.86 Series  
Electronic Handsets



Version 1.1



---

# Contents

## Read before use

The main technical parameters----- 1

Unlocking method----- 2

## Instructions for use

Unlocking method----- 3

Keys to unlock and lock----- 4

Electric locking and unlocking ----- 5

Emergency power supply unlock----- 6

Installing and replacing batteries----- 6

Reset ----- 7

## Instructions

Operation process icon definition----- 8

Factory mode----- 9

Register an administrator----- 9

Add administrator ----- 9

Add regular user----- 10

Remove administrator----- 10

Delete regular users----- 11

Set the door lock's opening direction----- 11

Automatic lock settings----- 12

Volume settings----- 13

Language settings ----- 13

Prevent-pry settings ----- 14

Restore factory mode----- 14

Turn on Bluetooth broadcast----- 15

Tuya APP Bluetooth connection settings ----- 15

Tuya APP function introduction----- 16

**✓ The main technical parameters**

Item	Description	Features
1	Password Unlock	Number of users: 100 (5 administrators + 95 ordinary users)
2	IC Card (Fob) Unlock	Number of users: 100 (5 administrators + 95 ordinary users)
3	Mechanical Key	2 Pcs
4	Operating Voltage	4 pcs 1.5V AA alkaline batteries
5	Alarm Voltage	$\leq 4.9V \pm 0.1V$
6	Emergency Power Supply	5V, Type-C
7	Quiescent Current	80~150uA
8	Dynamic Current	$\leq 300mA$
9	Antistatic Requirements	Contact discharge 8kv, air discharge 15kv
10	Operating Temperature	- 4 ~ 158
11	APP Unlock	TUYA BLE

## Read before use

### ✓ Unlocking method

#### 4 WAY OPEN

##### Unlocking method

1. Key
2. Password
3. IC Card (Fob)
4. Tuya Bluetooth APP



##### Password unlock

1. Supports 4~9 digit passwords
2. Number of users: 100 (5 administrators + 95 regular users)



##### IC Card (Fob) unlocking

1. Number of users: 100 (5 administrators + 95 regular users)



##### Dummy password

1. Random numbers can be added before or after the correct password.
2. Can support up to 20 digits.
3. This feature prevents the correct password from being viewed.

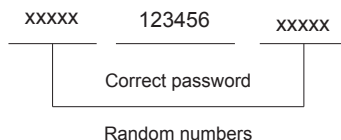

##### Alert prompt

1. When incorrect unlocking information is entered for 5 consecutive times, the system will automatically lock for 3 minutes.
2. If you enter incorrect information a total of 5 times within 2 minutes, the system will trigger an alarm. After 3 minutes of automatic locking, the system will clear the error record.
3. When the anti-pry alarm is turned on, if the anti-pry alarm system is triggered, the system will lock and sound an alarm for 90 seconds. (Factory default is switched to off)



##### Low voltage alarm

When the power is lower than 4.9V, the system will make a sound that the battery is low.

When the low battery prompt sounds, please replace the battery in time to avoid being unable to open the door.

If the door cannot be opened due to low battery, a mechanical key or emergency power supply can be used to temporarily unlock the door.

### ⚠ Notice

Please read and understand all instructions before use:

- The warranty does not apply if damage is caused by failure to follow these instructions.
- Only alkaline batteries can be used, other batteries are not recommended.
- When cleaning the product, please wipe it with a soft cloth.
- When the battery power is low and the alarm occurs, please replace the battery in time to keep the battery power sufficient.

\* The “electronic main control module” of this product (please refer to the basic product introduction) is dust-proof and water-resistant; tested under controlled laboratory conditions, its effect reaches IP65 level; dustproof and water-resistant functions are not permanently effective. Protective properties degrade due to daily wear and tear. Do not charge the smart lock (emergency power interface) when it is wet; damage caused by liquid entering the internal structure of the electronic lock is not covered by the warranty.

### ✓ Unlocking method

#### Use key to unlock

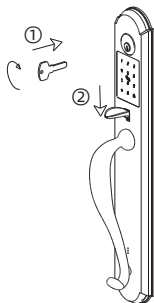

1. Insert the key into the keyhole of the lock and turn the key to retract the deadbolt.
2. Then press down the thumbpiece to open the door.

---

#### Use password to unlock

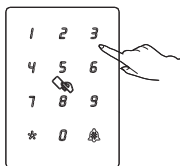

1. Touch to activate the button panel.
2. Enter the correct password and press "#" to confirm.
3. After being prompted to unlock, press down the mechanical button to open the door.

---

#### Unlock using IC card

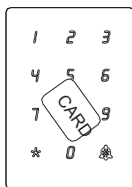

1. Place the "IC Card (Fob)" in the card swiping area.
2. After being prompted to unlock, press down the mechanical button to open the door.

---

#### Use Tuya APP to unlock the door

This product supports Tuya APP Bluetooth unlocking, please refer to "Page 15" of this manual for details.

### ✓ Keys to unlock and lock

#### Right door opening



Insert the key into the cylinder hole.

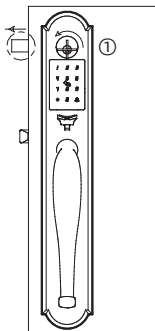

Rotate the key 180° counterclockwise to extend the deadbolt to lock the door.

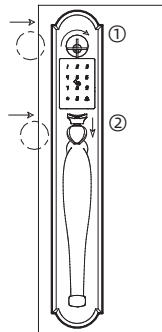

Rotate the key 90° clockwise, retract the deadbolt, press the thumbpiece downwards, retract the latch bolt, and then open the door.

#### Left door opening

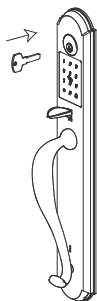

Insert the key into the cylinder hole.

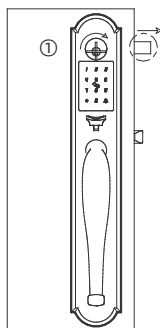

Rotate the key 180° clockwise to extend the deadbolt to lock the door.

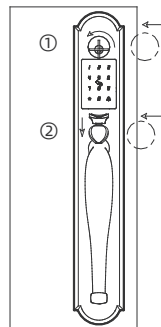

Rotate the key 90° counter-clockwise, retract the deadbolt, press the thumbpiece downwards, retract the latch bolt, and then open the door.

## ✓ Electric locking and unlocking

### Right door opening

#### Lock the door outside

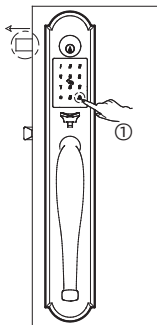

Press the “#” key, the deadbolt will automatically extend for locking.

#### Unlock the door outside

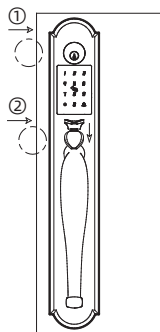

1. Enter the unlocking information (“password”, “card fob”) for unlocking verification. After successful verification, the deadbolt will retract automatically.
2. Press down the thumbpiece to retract the latch bolt to open the door.

#### Lock the door inside

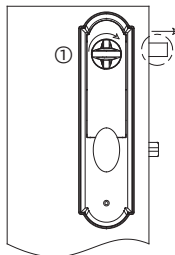

Turn the knob 90° clockwise to extend the deadbolt and lock it.

#### Unlock the door inside

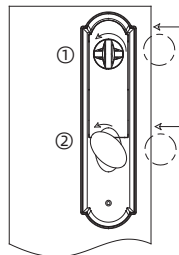

1. Turn the upper knob counterclockwise 90° and retract the deadbolt.
2. Rotate the lower oval knob 45° counterclockwise and retract the latch bolt to open the door.

### Left door opening

#### Lock the door outside

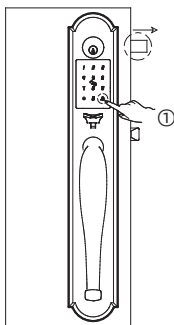

Press the “#” key, the deadbolt will automatically extend for locking

#### Unlock the door outside

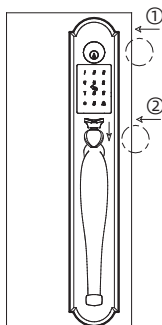

1. Enter the unlocking information (“password”, “card”) for unlocking verification. After successful verification, the deadbolt will retract automatically.
2. Press down the thumbpiece to retract the latch bolt to open the door.

#### Lock the door inside

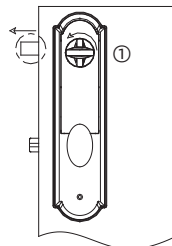

Rotate the knob 90° counterclockwise to extend the deadbolt and lock it.

#### Unlock the door inside

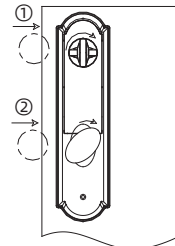

1. Turn the upper knob 90° clockwise and retract the deadbolt.
2. Rotate the lower oval knob 45° clockwise and retract the latch bolt to open the door.



### ✓ Emergency power supply unlock

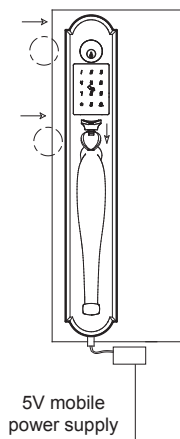

There is a Type-C USB backup power interface on the front panel. When the battery is low or completely dead, you can use the data cable to connect to the 5V mobile power supply, activate the door lock, enter the password or card, after successful verification, retract the deadbolt, then press down the thumbpiece to unlock the door.

#### ⚠ Notice

1. The Type-C emergency power interface only provides temporary power supply.
2. When using emergency power to power the lock, please complete the unlocking operation within 5 minutes.
3. When the lock is equipped with a battery, do not use the emergency power supply to power the lock for a long period of time to prevent battery corrosion and damage to the lock.

### ✓ Installing and replacing batteries

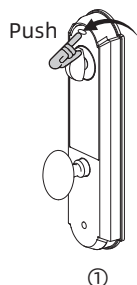

Press the battery cover first.

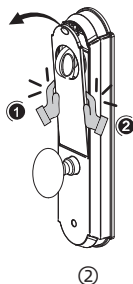

After the battery cover pops up, press the positions of "1" and "2", then remove the battery cover (As figure 2).

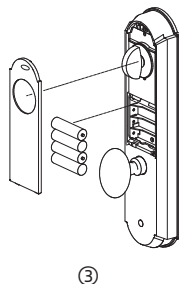

Install 4 pcs AA batteries.

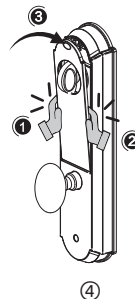

Place the battery cover on the back panel, and then press the position of "1", "2", and "3" in order to install the battery cover.

#### ⚠ Notice

1. Install the battery correctly.
2. Pay attention to the direction of the positive and negative poles of the battery and do not install it reversely.
3. Do not mix old and new batteries, as this will increase the internal resistance of the battery and damage the lock.

### ✓ Reset

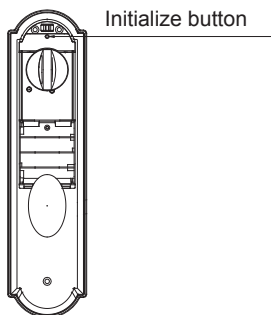

1. Open the battery cover.
2. Initialize button for 10 seconds (The system will prompt: 3 beeps).
3. The system prompts "Restore to factory mode" until the system prompts "Restore to factory mode completed".
4. After "Restore to Factory Mode" is completed, all locked data will be deleted.

### ✓ Operation process icon definition

**IN**

Enter “\*” + “#” to enter the operating system.

---

**AM**

Enter “Administrator” information.

---

**CARD**

Enter “card” information.

---

**\***

The “\*” key is the “return key” or “return to the previous level.”

---

**#**

“#” key: “confirm key” or “lock key”.

When the door is locked, this key can be used as a “doorbell”.

---



Touch screen to activate lock.

---



The prompt of “3 beeps” indicates operation failed or is invalid.  
Single “ding” is provided to indicate successful operation.

## Instructions

### ✓ Factory mode

1. When the lock is brand new or has been restored to factory mode, the initial password 123456 and any IC card can be used to unlock.
2. Touch to activate button panel, the system will prompt "There is no administrator in the system, please set up an administrator".

### ✓ Register an administrator



#### ⚠ Notice

1. In factory mode, there is no administrator in the system. Please register an administrator before use.
2. The lock can add "10" administrators; "5" password administrators; "5" card administrators; administrator number: "001~010".
3. When the passwords entered are different and the registration fails, the system will issue a "3 beeps" prompt.
4. The password cannot be set too simple, such as: consecutive "123456", repeating "111111"; a simple password cannot be registered.

### ✓ Add administrator

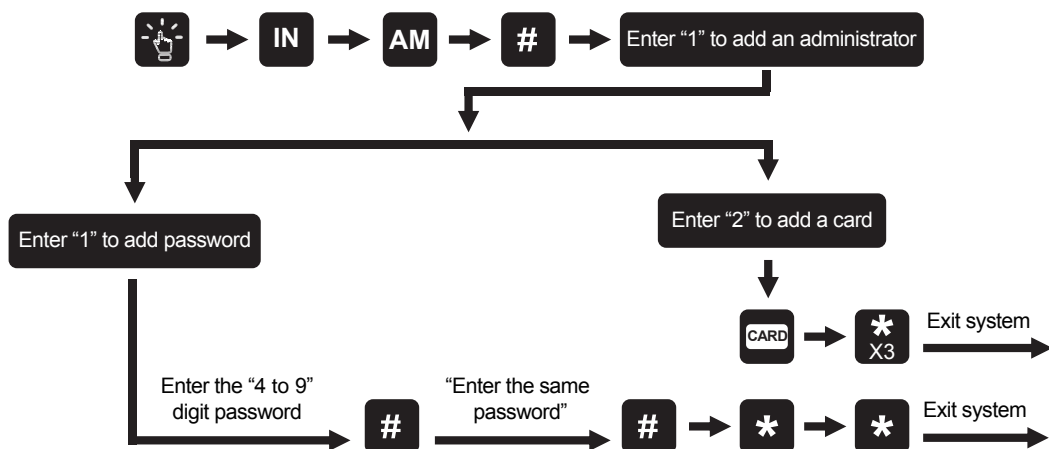

#### ⚠ Notice

1. The maximum number of administrators is 10; 5 password administrators; 5 card administrators; administrator number: 001~010.
2. The password cannot be set too simple, such as: 123456 in sequence, 111111 repeated; a simple password cannot be registered, and the system will issue a prompt sound "3 beeps" when registering a simple password.

## Instructions

### ✓ Add regular user

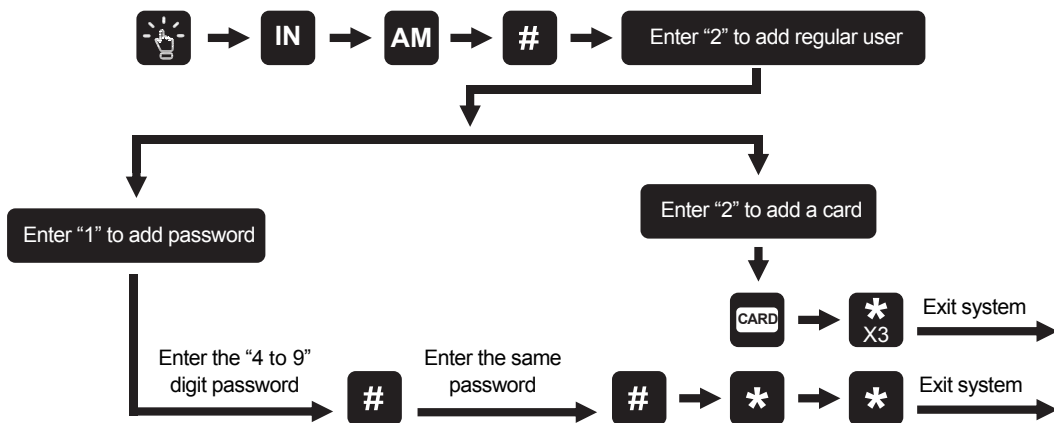

#### ⚠ Notice

1. The maximum number of regular users is 190pcs; regular user numbers: 011~200.
2. The password cannot be set too simple, such as: 123456 in sequence, 111111 repeated; a simple password cannot be registered, and the system will issue a prompt sound "3 beeps" when registering a simple password.

### ✓ Remove administrator

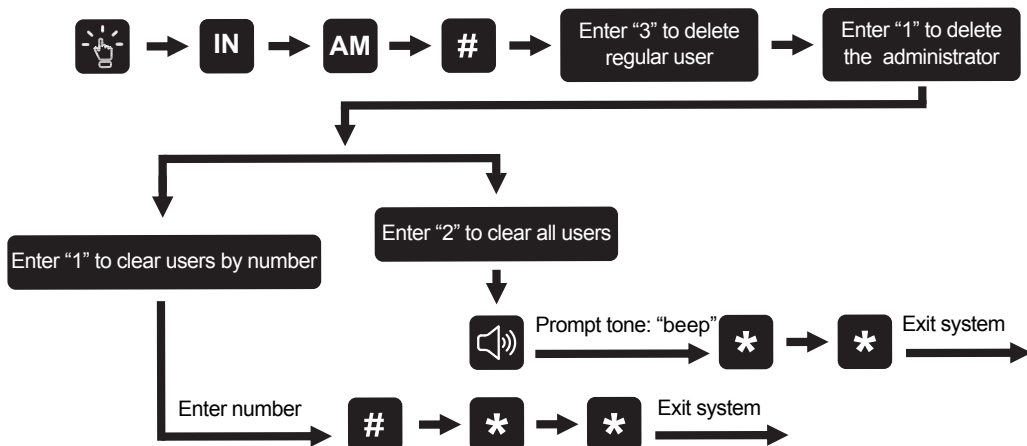

#### ⚠ Notice

1. When deleting an administrator, the currently logged-in administrator cannot be deleted.
2. An administrator password must be reserved for system settings; the last administrator password number retained will automatically become number 001.

## ✓ Delete regular users

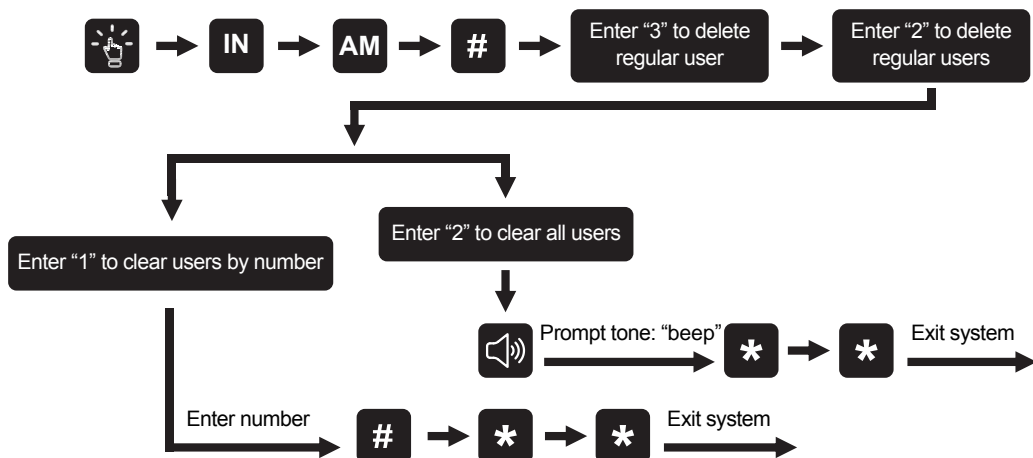

## ✓ Set the door lock's opening direction

Door opening direction calibration

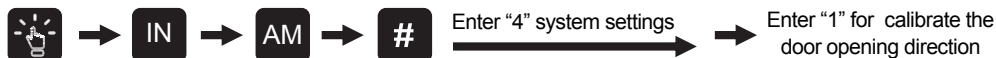

### ⚠ Notice

1. When starting the door opening direction calibration, the door lock will automatically determine the door opening direction. After the calibration is successful, the system will automatically exit.
2. If the system prompts "lock bolt blocked" during calibration, please wait until the system reports the error, manually rotate the knob (or use a key) to extend the closing tongue, and then perform "opening direction calibration" again.
3. Please ensure that the door lock is installed correctly. "Please refer to [Installation Instructions] for installation".

## ✓ Automatic lock settings

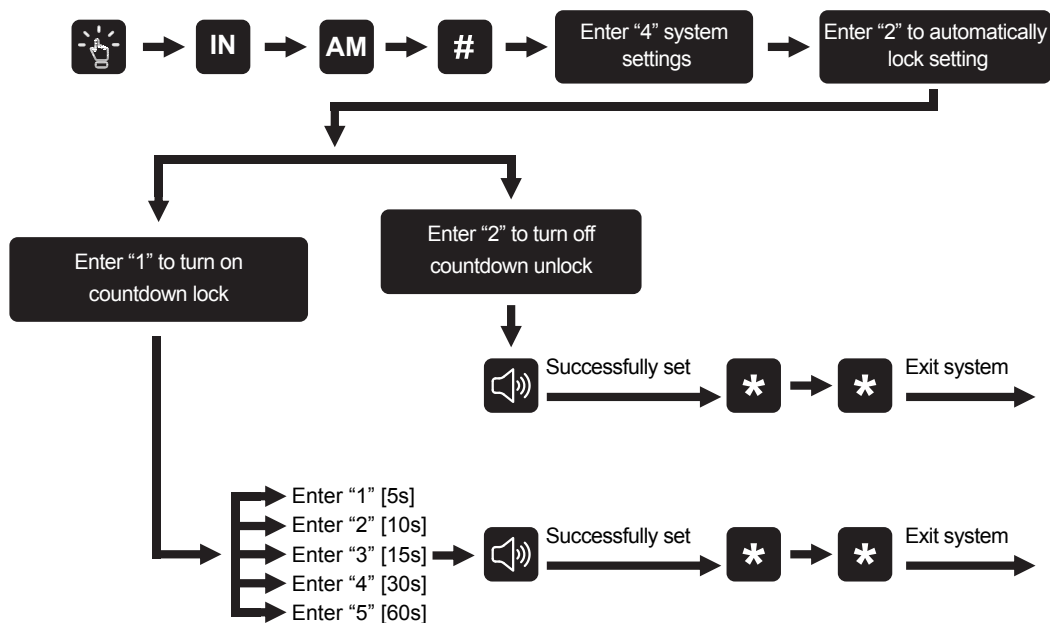

### ⚠ Notice

1. Activate the automatic lock setting. The system will automatically lock according to the set time.
2. Please choose an appropriate automatic locking time to avoid lock damage or other accidents.
3. When closing the door, please ensure that the deadbolt is in the "retract" state to avoid damage to the lock or other accidents.
4. Turn off the automatic locking setting, the lock will not automatically lock, and the lock must be manually rotated or key.

### ✓ Volume settings

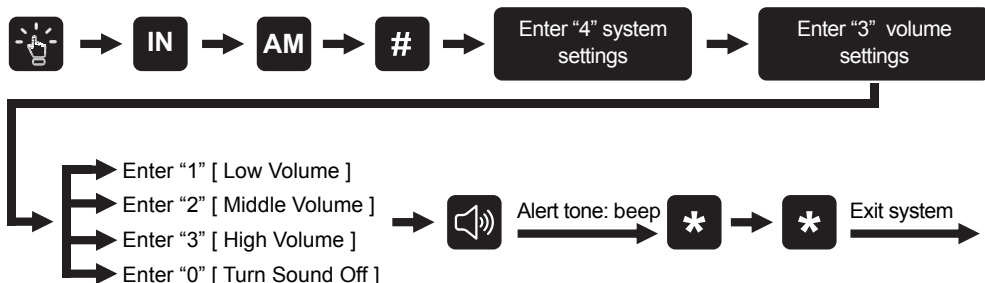

#### ⚠ Notice

1. The volume setting has 4 levels; "Low Volume", "Middle Volume", "High Volume" and "Turn Sound Off" can be set.
2. In "Low Volume", "Middle Volume", and "High Volume", all sounds in the system will be changed according to the settings.
3. In "Silent" mode, the "Doorbell" tone and "System Settings" tone will work normally.

### ✓ Language settings

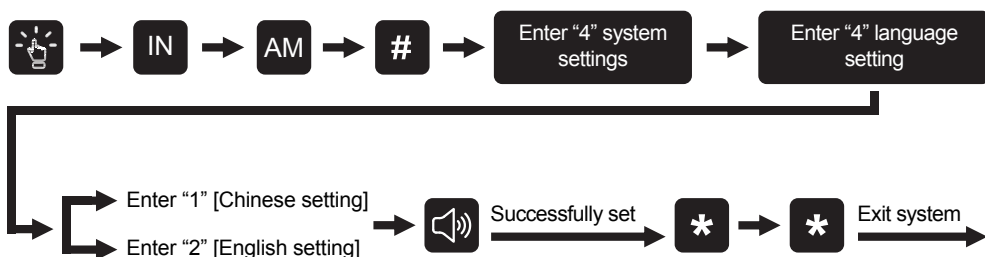

#### ⚠ Notice

1. The door lock factory setting defaults to English.
2. When changing the door lock language, you must first register an administrator before entering the system to change the language.



## Instructions

### ✔ Prevent-pry settings

In order to prevent malicious prying of the door lock (or malicious damage), this product is equipped with an anti-pry alarm function and the anti-pry switch position (as shown in the picture).

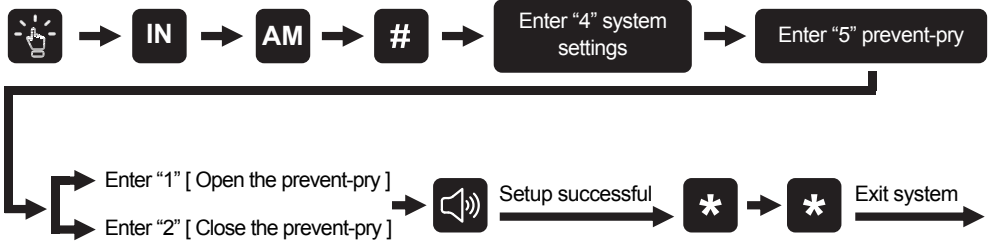
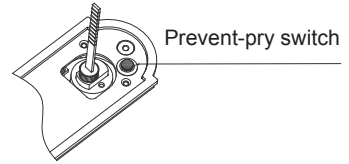

#### ⚠ Notice

1. The factory setting of the door lock is set to "off" by default.
2. After turning on the prevent-pry setting, if the anti-tamper alarm system is triggered, the system will lock and sound an alarm for 180 seconds.
3. After the prevent-pry alarm system is triggered, the battery can be removed and reinstalled or the lock can be operated normally after waiting for 180 seconds.
4. Turn off the prevent-pry setting, the anti-pry system is inactive, and the system will not alarm or lock when the anti-tamper switch is touched.

### ✔ Restore factory mode

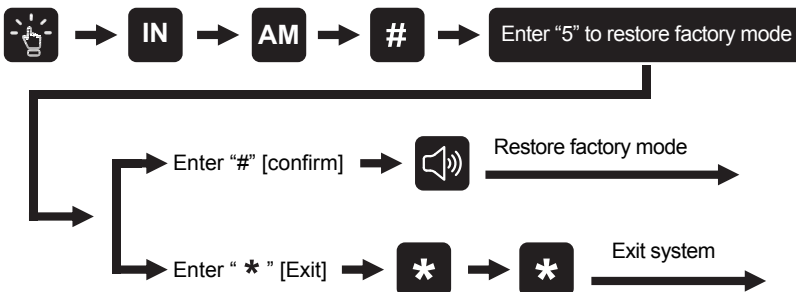

#### ⚠ Notice

1. Restoring to factory mode will clear all unlocking information and operation records, please operate with caution.

## Instructions

---

### ✓ Turn on Bluetooth broadcast



#### ⚠ Notice

1. When the lock is in factory mode, Bluetooth broadcast is automatically turned on by default.
2. After the lock is registered as an administrator, the administrator needs to be verified to enable Bluetooth broadcasting.
3. When the lock Bluetooth is turned on and the mobile APP is not connected, the lock Bluetooth will be turned off after 20 seconds.

### ✓ Tuya APP Bluetooth connection settings

The door lock supports Tuya Bluetooth protocol (2.4G Bluetooth protocol).

You can connect to "Tuya APP" to help manage your locks. Search "Tuya" in the app store to get "Tuya APP".

1. Search "Tuya" in the app market to get "Tuya APP".
2. Turn on Bluetooth on your phone and open "Tuya APP".
3. Register an APP account via email. If you already have an account, please log in.
4. Turn on Bluetooth broadcasting on the lock (refer to Turning on Bluetooth Broadcasting), click "Add Device" in the APP, the APP will display the available locks at the top with the "Add" icon.
5. Click "Add". After the Bluetooth connection is established, click "Finish" to complete the pairing connection.

### Tuya APP function introduction

1. Bluetooth unlocking
  2. Unlock with temporary password
  3. Member management
  4. APP adds user unlocking information
  5. Unlocking record query
  6. System language and volume
- For more functions, please check the APP description

#### Notice

1. Please do not try to disassemble this product by yourself, otherwise you may get an electric shock or damage the product.
2. Do not use hard or heavy objects to hit this product.
3. When going out, please make sure the lock is locked before leaving.
4. Please be careful not to hit the handle to avoid injury.
5. Do not use any corrosive cleaners to clean this product, such as gasoline, cleaners containing alcohol, etc., otherwise it will cause damage to the electronic circuit, product degradation, or paint peeling.
6. Please change your password regularly (about three months); when your password is leaked, please change your password in time; our company is not responsible for accidents caused by user negligence.
7. When using manual mode to lock, be sure to confirm whether the door is closed and locked.
8. Do not use rechargeable batteries, only alkaline batteries are recommended.
9. Please be sure to follow the above instructions to avoid any injury or property damage.
10. The performance of this product cannot be guaranteed in special situations and environments such as water vapor condensation and the seaside.

